



Electrolux

Hand held Mixers Bermixer Plus Portable Mixer 450W with Stainless Steel Tube 18"



Hand held Mixers

Bermixer Plus Portable Mixer 450W with
Stainless Steel Tube 18"

603551 (BMX450T45U)

BP450 BERMIXER + S/S
TUBE 18" 450W-US

Short Form Specification

Item No.

BP45040-B3000 Bermixer, portable, hand held, variable speed, handle grip, with 18" cutter tube, 1/2 HP, 450 watt, 115v/60/1, 4.1 amps, NEMA 5-15P



APPROVAL:

ITEM #

MODEL #

NAME #

SIS #

AIA #

Main Features

- Parts in contact with food - tube, blade, shaft - can be completely dismantled without tools for easy cleaning.
- Delivered with:
 - flat base motor
 - stainless steel tube
 - space saving storing wall support.
- Light weight, ergonomic grip and adjustable speeds make preparation tasks fast and easy.
- Anti-splash bell knife design.
- Bayonet system makes fast and simple to exchange tools.
- Overheating warning red indicator.
- Tube, knife and whisks are dishwasher safe.
- Safety feature requires both hands to start the mixer (no volt release system).
- Removable rotor and mechanism to facilitate cleaning.
- Convenient grip and adjustable speeds make preparation tasks fast and easy.
- Very easy to use, assemble and dismantle.
- Bayonet system to easily remove accessories without the use of tools.
- Red luminous indicator flashes when the device is overloaded.
- Its light weight ensures an optimum comfort for the user.
- Thanks to its electronic speed variator, a quick press with the thumb on the selector is all you need to change speeds.
- Productivity suitable for 50 to 300 meals per service.

Construction

- Power: 450 watts.
- Maximum speed 9000 rpm.
- Motor has an air cooling system and is protected against overheating (in case of long intensive work).
- Smart speed control to ensure the right power according to the work load.
- Motor protected from overload by a terminal fuse (alert system).

Included Accessories

- 1 of Cutter Tube, 18" for B3000 models PNC 653575
(replaces discontinued PNC 653556)
(NOTE: Not compatible with old motor)

Optional Accessories

- Adjustable Rail, for containers 15" - 26", PNC 653292
for hand held mixer B3000 ☐
- Bowl Cradle, for hand held mixer B3000 PNC 653294
☐
- 14" Cutter Tube Attachment PNC 653574
☐
- Cutter Tube, 18" for B3000 models PNC 653575
(replaces discontinued PNC 653556) ☐
(NOTE: Not compatible with old motor)



Electrolux

Bermixer Plus Portable Mixer 450W with Stainless Steel Tube 18" Hand held Mixers

Electrolux Professional, Inc.

www.electroluxusa.com/professional

10200 David Taylor Drive, Charlotte, NC 28262 • Telephone Number: 866-449-4200 • Fax Number: 704-547-7401



Electrolux

**Hand held Mixers
Bermixer Plus Portable Mixer 450W
with Stainless Steel Tube 18"**

- Cutter Tube, 22" for B3000 models
(replaces discontinued PNC 653557)
(NOTE: Not compatible with old motor) PNC 653576 □
- Reinforced Whisk, for hand held mixer
B3000 (replaces discontinued PNC
653554) (NOTE: Not compatible with old
motor) PNC 653578 □

Front

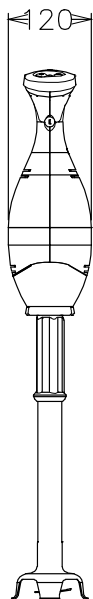

Top

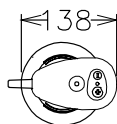

Side

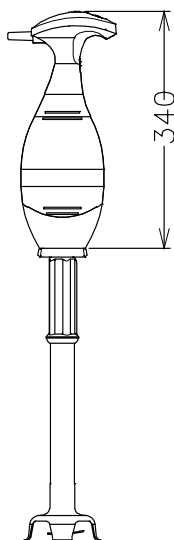

EI = Electrical connection

EQ = Equipotential screw

Electric

Supply voltage:

603551 (BMX450T45U) 110...120 V/1N ph/50/60 Hz

Electrical power:

0.45 kW

Total Watts:

0.45 kW

Key Information:

External dimensions, Width: 5 7/16" (138 mm)

External dimensions, Depth: 4 3/4" (120 mm)

External dimensions, Height: 30 1/8" (765 mm)

Shipping width: 14 9/16" (370 mm)

Shipping depth: 27 9/16" (700 mm)

Shipping height: 5 1/8" (130 mm)

Shipping weight: 10 lbs (4.7 kg)